

REV	ZONE	ECN	REVISION DESCRIPTION	DATE	ENG
A	Released	3/19	PRD

ITEM NO.	PART NUMBER	DESCRIPTION	QTY.
1	192004-03	Front Plate (1.125 ID)	1
2	192038	Riser 1.00 (3/8-16)	3
3	192003-04	Center Plate (.900 ID)	1
4	192039	Eccentric Roll Pin (.015)	3
5	192036	Carbide Bushing	4
6	192002	Shank - Adjusting Gear	1
7	192016	Washer (Ring Style)	1
8	140366	Screw: LHCS, 3/8-16 x .750	3
9	134205	Bolt: Hex, 3/8-16 x 1.50, Grade 8	3
10	192017	Thrust Bearing	3
11	192018	Thrust Washer	6
12	101027	Screw: SSS, #1/4-28 x .250 Cup Pt.	3
13	192040	Pinion Arbor	1
14	192041	Adjusting Sleeve (Pinion)	1
15	836-B-6-6	Screw: BHCS, #8-32 x .375	1
16	192044	Thrust Washer	1
17	192042	Spring Retainer	1
18	192046	Spring: Compression, .845 OD x 3.00	1
19	125156	Screw: SHCS, #8-32 x .375	1
20	192047	Spline Brake	1
21	192050-01	Thrust Washer	3
22	192008	Eccentric Gear	3

THIS DRAWING IS THE CONFIDENTIAL AND EXCLUSIVE PROPERTY OF C.J. WINTER MACHINE TECHNOLOGIES, INC. AND MAY NOT BE COPIED, REPRODUCED, OR DISCLOSED IN ANY WAY, WHATSOEVER, TO ANYONE WITHOUT THE EXPRESS WRITTEN PERMISSION OF C.J. WINTER MACHINE TECHNOLOGIES, INC. UNLAWFUL DISCLOSURE MAY RESULT IN PROSECUTION
© 2004 C.J. WINTER MACHINE TECHNOLOGIES, INC.

UNLESS OTHERWISE SPECIFIED:
DRAWING MUST COMPLY TO
C. J. WINTER ENGINEERING
STANDARD E1058 & ASME
Y14.5M 1994. UNTOLERANCED
DIMENSIONS ARE BASIC

	.020	A	B	C	SW
--	------	---	---	---	----

DRAWN BY: P.Diliberto
DWG DATE: 3/7/19
ENG. APPR: P.Allart
APPR DATE: 3/7/19
MATERIAL: See BOM
HEAT TRT:



C. J. WINTER
MACHINE TECHNOLOGIES, INC.

Spline Attachment

DWG SIZE
B
SCALE: 1:8
SHEET 1 OF 3
DRAWING NO.
192 ES-04

6

5

4

3

2

1

REV	ZONE	ECN	REVISION DESCRIPTION	DATE	ENG
A	Released	3/19	PRD

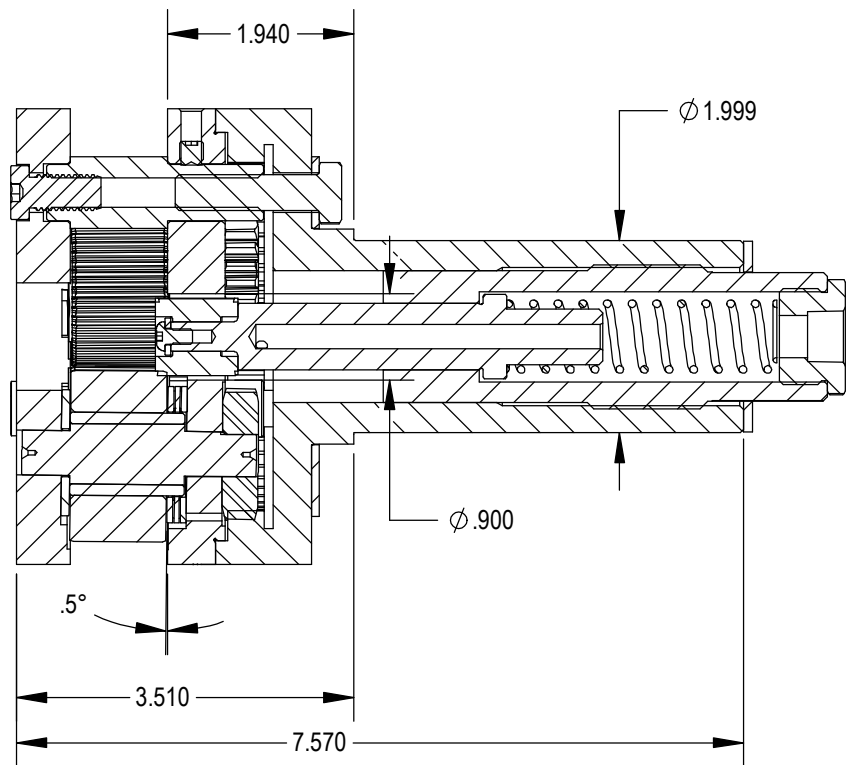
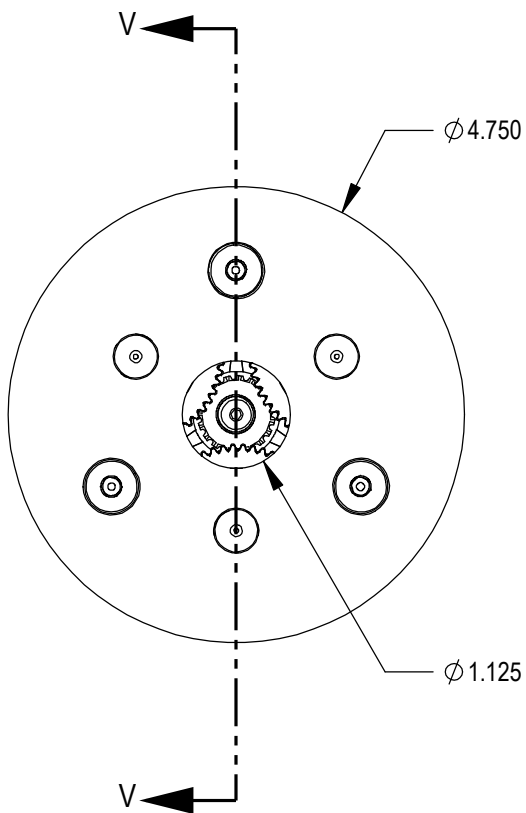
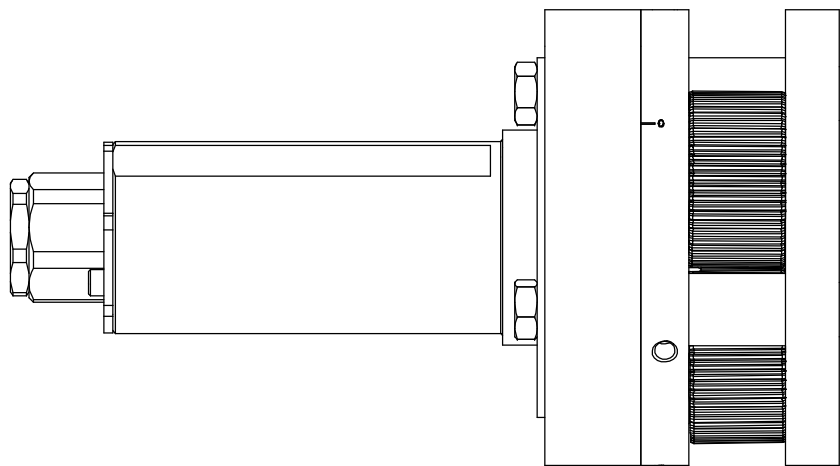
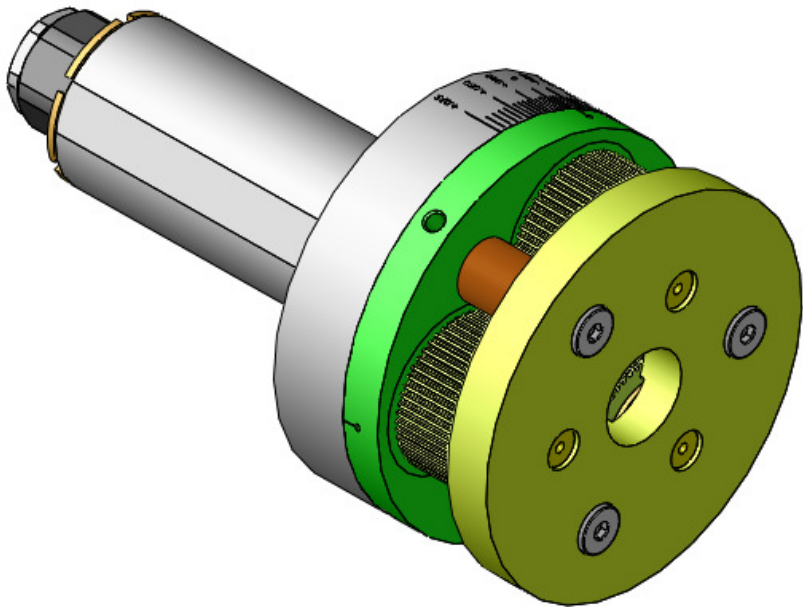

SECTION V-V
SCALE 1 : 2

THIS DRAWING IS THE CONFIDENTIAL AND EXCLUSIVE PROPERTY OF C.J. WINTER MACHINE TECHNOLOGIES, INC. AND MAY NOT BE COPIED, REPRODUCED, OR DISCLOSED IN ANY WAY, WHATSOEVER TO ANYONE WITHOUT THE EXPRESS WRITTEN PERMISSION OF C.J. WINTER MACHINE TECHNOLOGIES, INC UNLAWFUL DISCLOSURE MAY RESULT IN PROSECUTION

UNLESS OTHERWISE SPECIFIED:
DRAWING MUST COMPLY TO
C. J. WINTER ENGINEERING
STANDARD E1058 & ASME
Y14.5M 1994. UNTOLERANCED
DIMENSIONS ARE BASIC

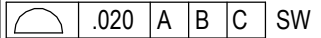

DRAWN BY: P.Diliberto
DWG DATE: 3/7/19
ENG. APPR: ...
APPR DATE: ...
MATERIAL: ...
HEAT TRT: ...



C. J. WINTER
MACHINE TECHNOLOGIES, INC.

Spline Attachment

DWG SIZE
SCALE: 1:4
B
SHEET 2 OF 3
DRAWING NO.
192 ES-04

REV	ZONE	ECN	REVISION DESCRIPTION	DATE	ENG
A	Released	3/19	PRD

LaserMarking Detail

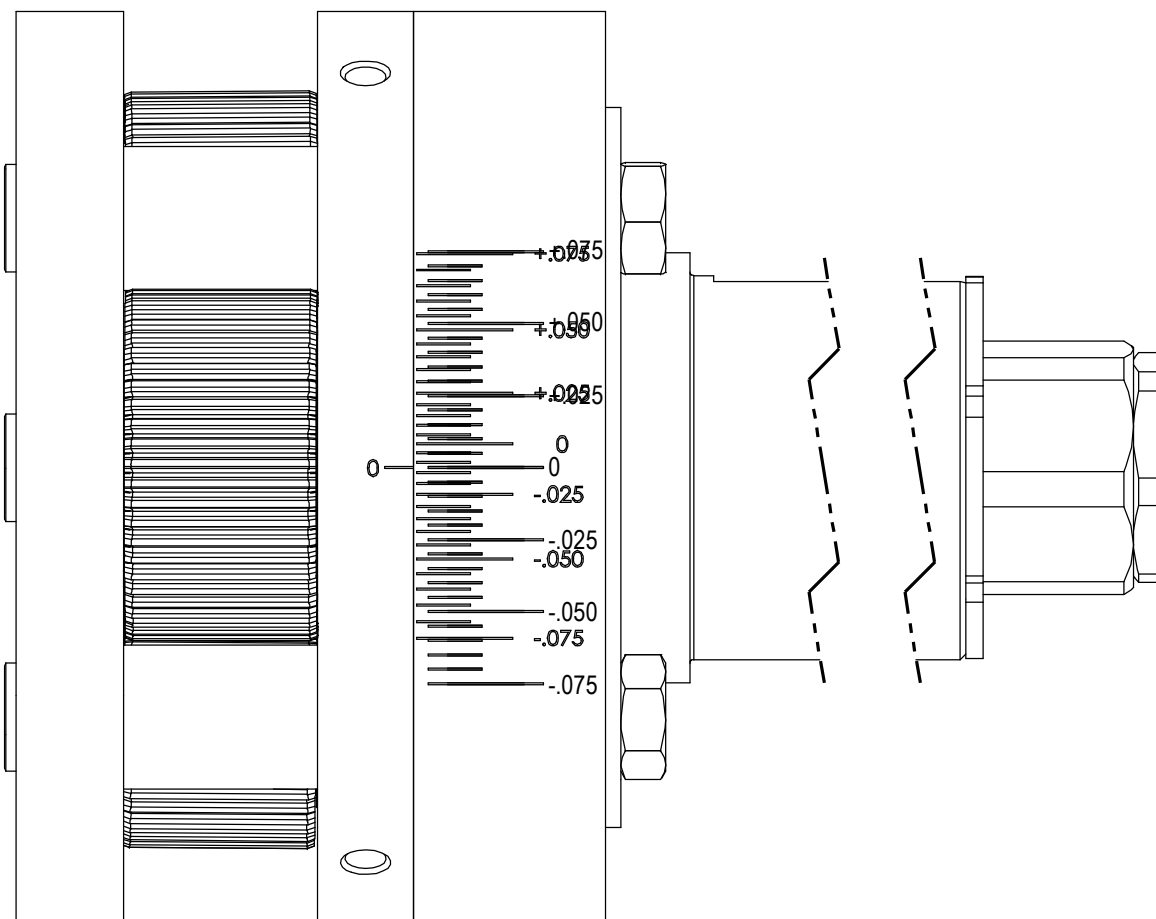
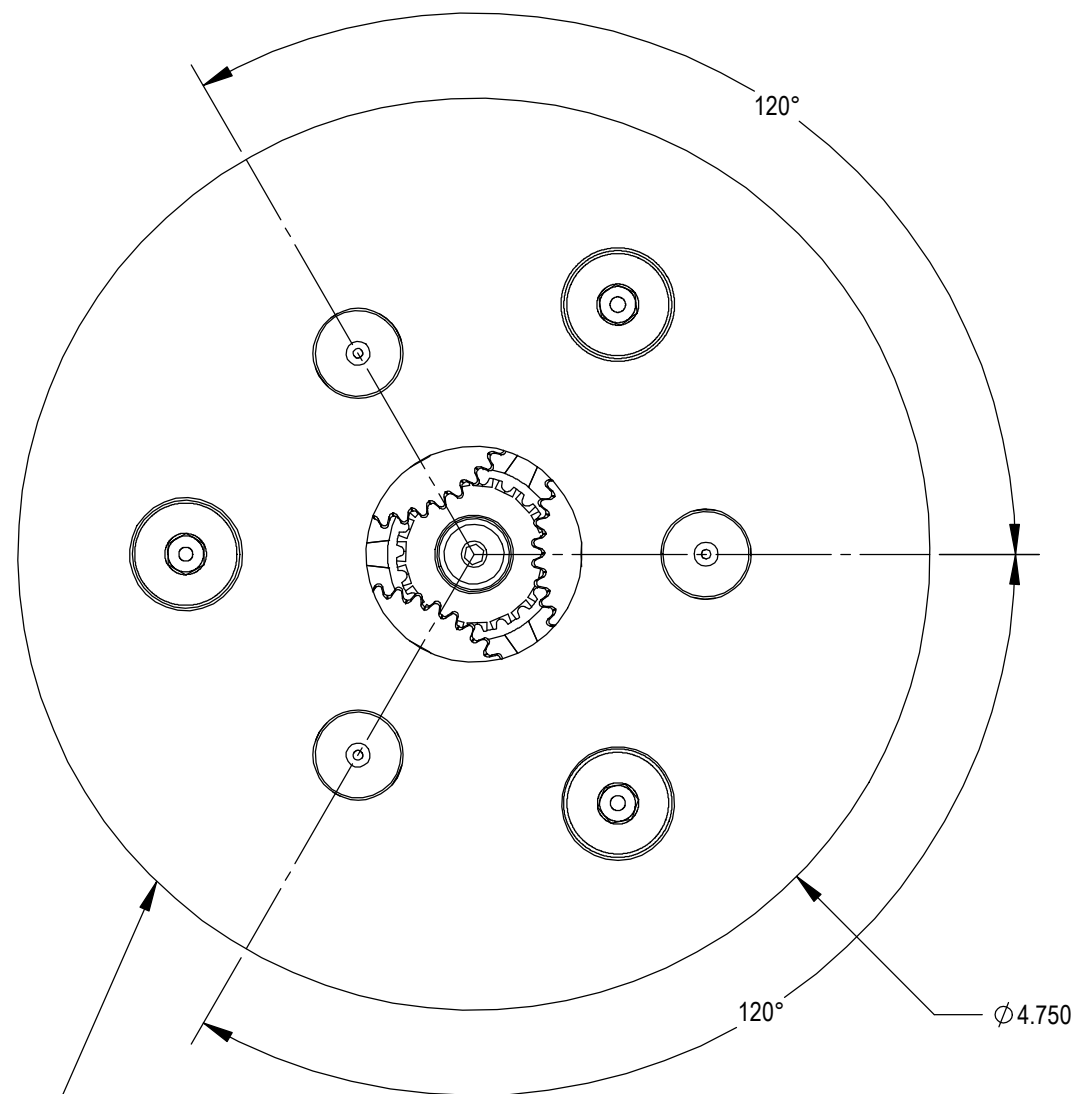

Scale	Chordal position
0.075	1.035
0.070	0.941
0.065	0.850
0.060	0.764
0.055	0.682
0.050	0.604
0.045	0.529
0.040	0.458
0.035	0.390
0.030	0.325
0.025	0.264
0.020	0.205
0.015	0.149
0.010	0.097
0.005	0.047
0.000	0.000
-0.005	-0.047
-0.010	-0.097
-0.015	-0.149
-0.020	-0.205
-0.025	-0.264
-0.030	-0.325
-0.035	-0.390
-0.040	-0.458
-0.045	-0.529
-0.050	-0.604
-0.055	-0.682
-0.060	-0.764
-0.065	-0.850
-0.070	-0.941
-0.075	-1.035

Mark Scale in 3 Places, Every 120°
Visually Align -0- with roll pin within +/- 10°

PRIOR TO MARKING - SET HEAD TO CENTER OF ADJUSTMENT

- 1) Loosen 3 Hex Bolts Near Shank
- 2) Twist Head Until Fully Closed, Mark Across Both Parts w/ Sharpie
- 3) Twist Head Until Fully Open, Mark Across Both Parts w/ Sharpie
- 4) Adjust Until Mark on Head is Exactly 1/2 way Between Sharpie Marks
- 5) Tighten Hex Bolts

THIS DRAWING IS THE CONFIDENTIAL AND EXCLUSIVE PROPERTY OF C.J. WINTER MACHINE TECHNOLOGIES, INC. AND MAY NOT BE COPIED, REPRODUCED, OR DISCLOSED IN ANY WAY, WHATSOEVER TO ANYONE WITHOUT THE EXPRESS WRITTEN PERMISSION OF C.J. WINTER MACHINE TECHNOLOGIES, INC. UNLAWFUL DISCLOSURE MAY RESULT IN PROSECUTION

UNLESS OTHERWISE SPECIFIED:
DRAWING MUST COMPLY TO
C. J. WINTER ENGINEERING
STANDARD E1058 & ASME
Y14.5M 1994. UNTOLERANCED
DIMENSIONS ARE BASIC

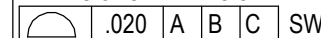

DRAWN BY: P.Diliberto
DWG DATE: 3/7/19

ENG. APPR: ...
APPR DATE: ..

MATERIAL: ..
HEAT TRT:



C. J. WINTER
MACHINE TECHNOLOGIES, INC.

Spline Attachment

DWG SIZE
B
SCALE: 1:4
Sheet 3 of 3

DRAWING NO.
192 ES-04