

REV	ZONE	ECN	REVISION DESCRIPTION	DATE	ENG
C	Redrawn in Solidworks	3/22	NA

SECTION A-A

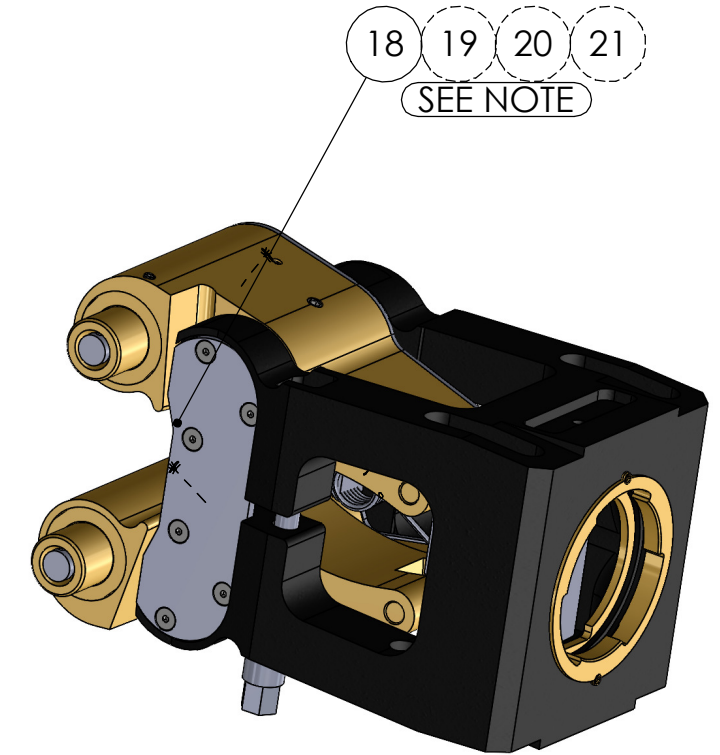

SECTION B-B

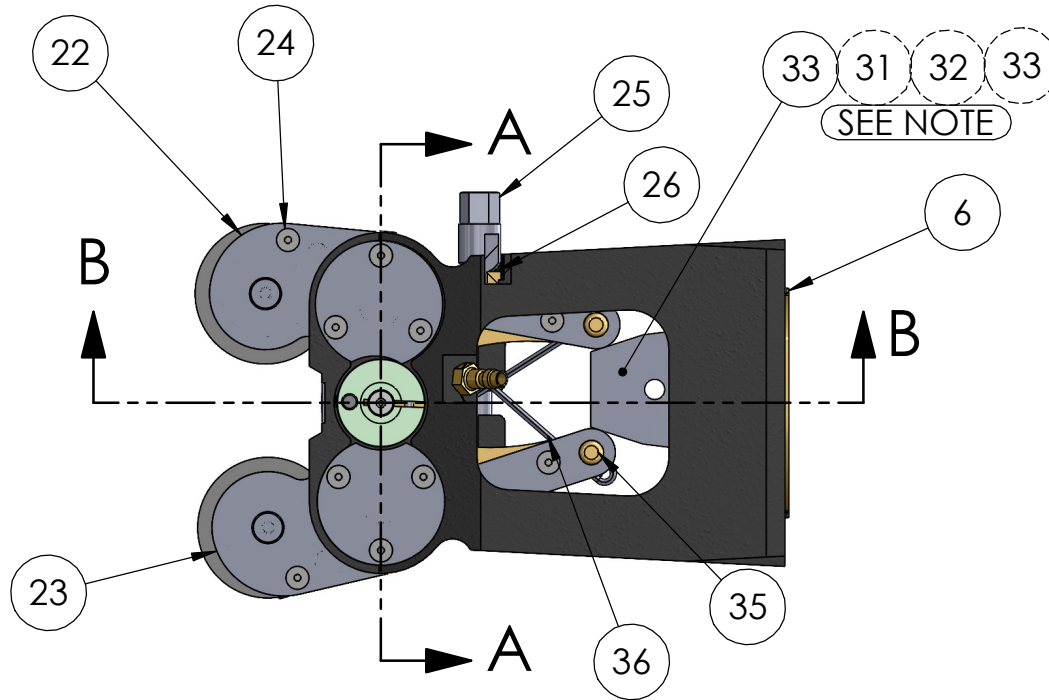
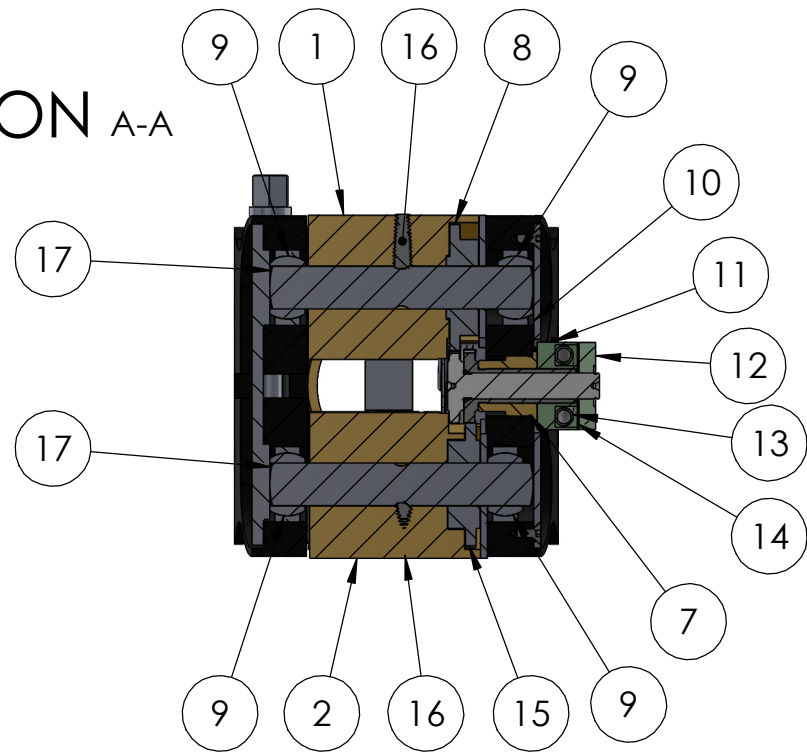
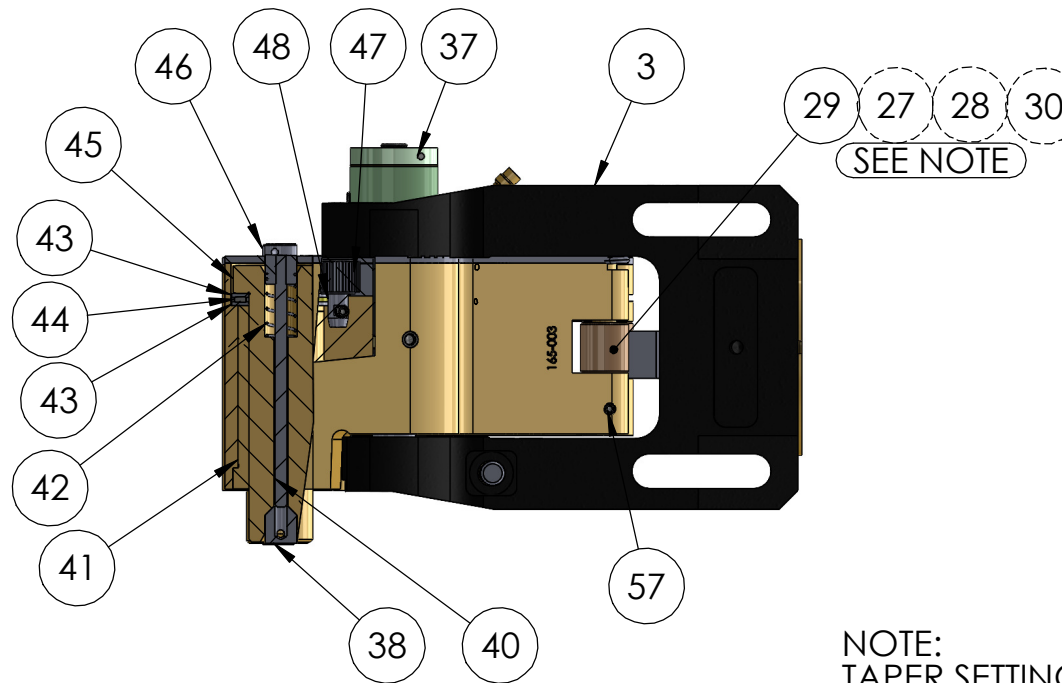
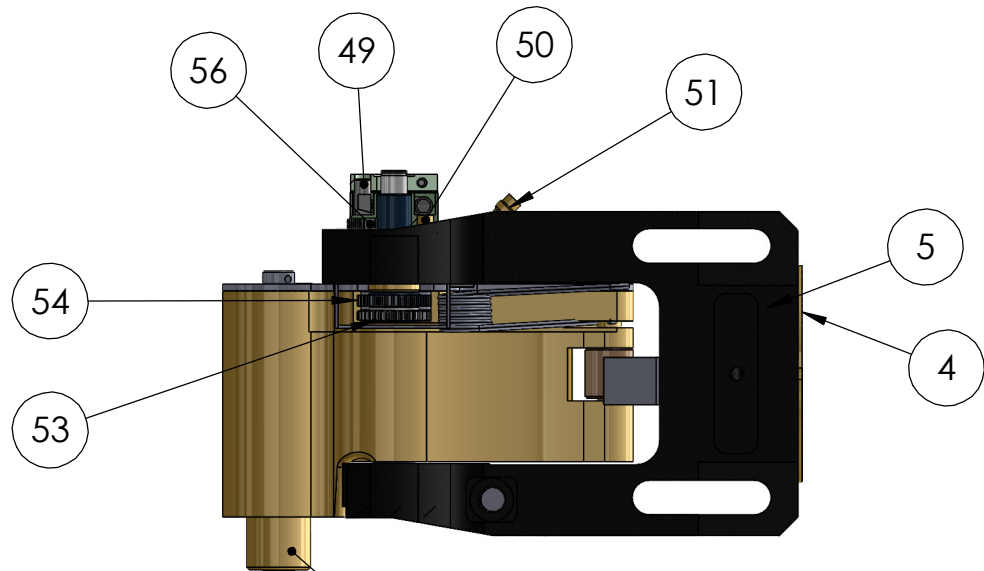

NOTE:
TAPER SETTING PLATE, WEDGE, AND WEDGE ROLLER, SHOWN IN BOM AS PARTS 18, 33, AND 29 RESPECTIVELY MAY BE SUBSTITUTED FOR DIFFERENT THREAD OR TAPER ADJUSTMENT CONFIGURATIONS

THIS DRAWING IS THE CONFIDENTIAL AND EXCLUSIVE PROPERTY OF C.J. WINTER MACHINE TECHNOLOGIES, INC. AND MAY NOT BE COPIED, REPRODUCED, OR DISCLOSED IN ANY WAY, WHATSOEVER TO ANYONE WITHOUT THE EXPRESS WRITTEN PERMISSION OF C.J. WINTER MACHINE TECHNOLOGIES, INC. UNLAWFUL DISCLOSURE MAY RESULT IN PROSECUTION
© 2004 C.J. WINTER MACHINE TECHNOLOGIES, INC.

UNLESS OTHERWISE SPECIFIED:
DRAWING MUST COMPLY TO C. J. WINTER ENGINEERING STANDARD E1058 & ASME Y14.5M 1994. UNTOLERANCED DIMENSIONS ARE BASIC

DRAWN BY:
DWG DATE:
ENG. APPR:
APPR DATE:
MATERIAL:
HEAT TRT:

C. J. WINTER MACHINE TECHNOLOGIES, INC.	DWG SIZE	SCALE: 1:3
	B	SHEET 1 of 2
165913: Bracket Assembly		DRAWING NO. 1650B1

6

5

4

3

2

1

6

5

4

3

2

1

