

REV	ZONE	ECN	REVISION DESCRIPTION	DATE	ENG
A	5513	Released	3/12/18	JMH

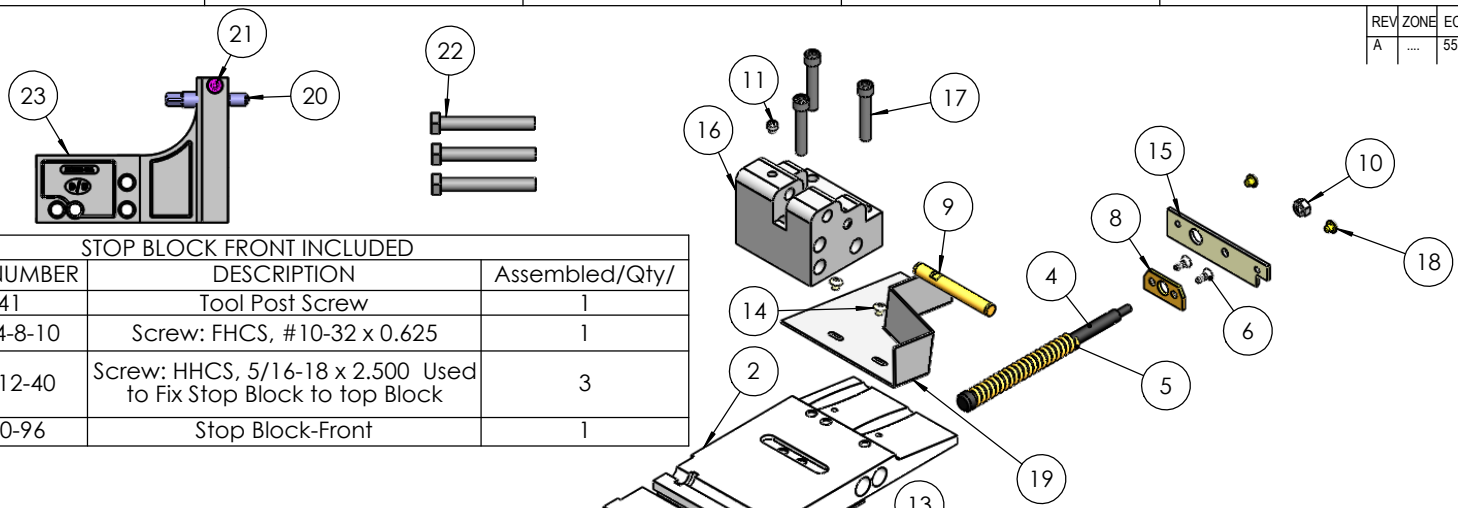

STOP BLOCK FRONT INCLUDED

ITEM NO.	PART NUMBER	DESCRIPTION	Assembled/Qty/
20	741	Tool Post Screw	1
21	836-4-8-10	Screw: FHCS, #10-32 x 0.625	1
22	835-12-40	Screw: HHCS, 5/16-18 x 2.500 Used to Fix Stop Block to top Block	3
23	5080-96	Stop Block-Front	1

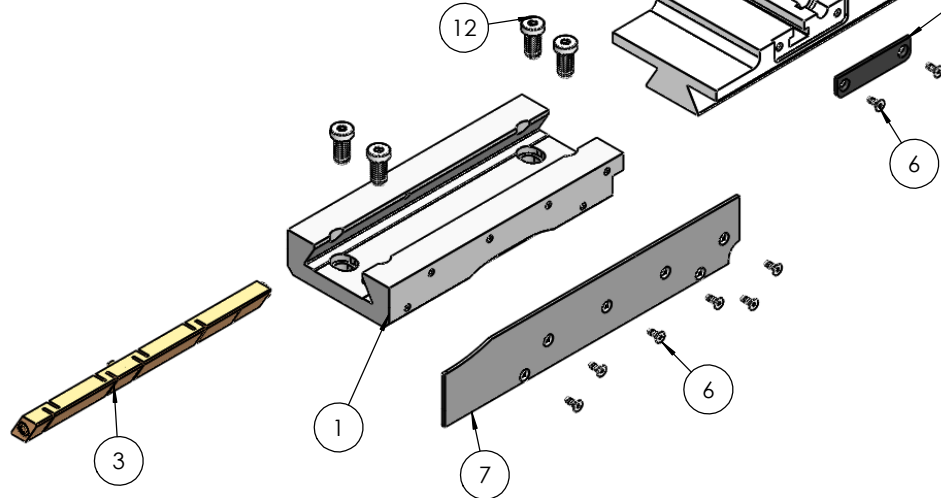

ITEM NO.	PART NUMBER	DESCRIPTION	Assembled/QTY.
1	132003-I	Base for 132000	1
2	132001-I	Machined Slide for 132EG	1
3	132058	Gib - Expansion Style	1
4	132004	Spring Screw for 132 EG	1
5	132005	Spring: Compression, .466 OD x 3.50	1
6	132006	Screw: FHCS, #6-32 x .250	10
7	132010	Chip Guard 132 -A- Position	1
8	132009	Spring Retainer for 132 EG	1
9	132012	Drive Pin 132 -A- Position	1
10	132014	Nut: Hex, #10-32 w/Nylon Insert	1
11	140280	Screw: SSS, 1/4-28 x .250 Half Dog	1
12	140366	Screw: LHCS, 3/8-16 x .750	4
13	132066	T-Slot Cover	1
14	836-B-6-4	Screw: BHCS, #8-32 x .250	2
15	132008	Base Endcap for 132 EG	1
16	132031	TOP BLOCK FOR A-POSITION SLIDE	1
17	834-A-11-22	SHCS 1/4-28 X 1.375 LONG	3
18	836-B-5-4	Screw: BHCS, #6-32 x .250	2
19	5080-91-G-1	Front Cross Slide Gaurd	1

THIS DRAWING IS THE CONFIDENTIAL AND EXCLUSIVE PROPERTY OF C.J. WINTER MACHINE TECHNOLOGIES, INC. AND MAY NOT BE COPIED, REPRODUCED, OR DISCLOSED IN ANY WAY, WHATSOEVER TO ANYONE WITHOUT THE EXPRESS WRITTEN PERMISSION OF C.J. WINTER MACHINE TECHNOLOGIES, INC. UNLAWFUL DISCLOSURE MAY RESULT IN PROSECUTION © 2004 C.J. WINTER MACHINE TECHNOLOGIES, INC.

UNLESS OTHERWISE SPECIFIED: DRAWING MUST COMPLY TO C. J. WINTER ENGINEERING STANDARD E1058 & ASME Y14.5M 1994. UNTOLERANCED DIMENSIONS ARE BASIC

DRAWN BY: S. Belpanno
 DWG DATE: 06/01/99
 ENG. APPR: J. Snow
 APPR DATE: 06/01/99
 MATERIAL: See BOM
 HEAT TRT:



C. J. WINTER
 MACHINE TECHNOLOGIES, INC.

132EG Series Slide: A Position

DWG SIZE: B
 SCALE: 1:5
 Sheet1
 DRAWING NO. 132EGA

.020 A B C SW