

6

5

4

3

2

1

REV	ZONE	ECN	REVISION DESCRIPTION	DATE	ENG
	Released	XXXX	XXXX

ITEM NO.	PART NUMBER	DESCRIPTION	QTY.
1	111-01	Center Shave Tool Assembly	1
2	111-11	Second Position Tool Block Assembly	1
3	111007	Taper Arm - 3rd Position	1
4	111005	Taper Arm 1st Position	1
5	111202	Dovetail Adapter Plate (3rd)	1
6	111059-M	Expansion Locking Gib (1st & 3rd)	1
7	111026	Screw, FHCS, #10.32 x .750	1

D

C

B

A

D

C

B

A

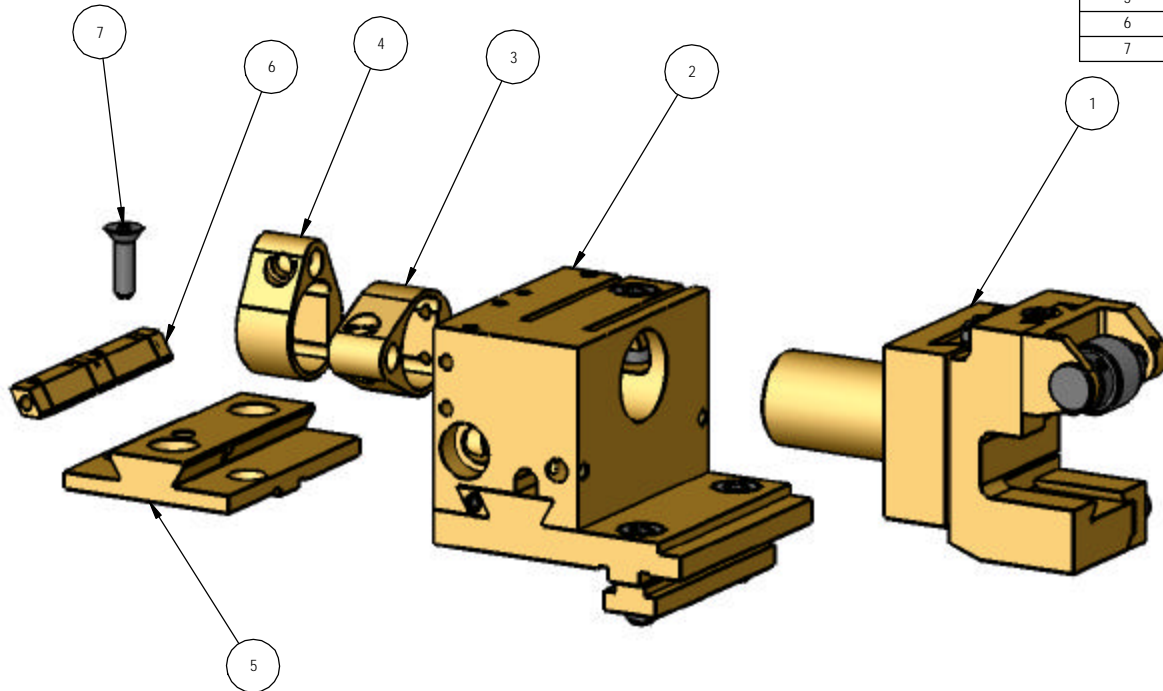

THIS DRAWING IS THE CONFIDENTIAL AND EXCLUSIVE PROPERTY OF C.J. WINTER MACHINE TECHNOLOGIES, INC. AND MAY NOT BE COPIED, REPRODUCED OR DISCLOSED IN ANY WAY, WHATSOEVER, TO ANYONE WITHOUT THE EXPRESS WRITTEN PERMISSION OF C.J. WINTER MACHINE TECHNOLOGIES, INC. UNLAWFUL DISCLOSURE MAY RESULT IN PROSECUTION.
 © 2014 C.J. WINTER MACHINE TECHNOLOGIES, INC.

UNLESS OTHERWISE SPECIFIED, DRAWING MUST COMPLY TO C.J. WINTER ENGINEERING STANDARD E1058 & ASME Y14.5M 1994. UNTOLERANCED DIMENSIONS ARE BASIC.

0.020 A B C SW

DRAWN BY: E. Pacavari
 DWG DATE: 12/17/04
 ENG APPR:
 APPR DATE:
 MATERIAL:
 HEAT TRT:



Shave Tool and 1st/2nd/3rd Position Block

DWG SIZE: SCALE: 1:1.25
B
 SHEET 1 OF 1
 DRAWING NO:
111-18

6

5

4

3

2

1